

H-Power Remote 4 + 4

is the bi-directional coupling system for 4 sensor signals and 4 actuator control signals.

This system inductively transmits signals in both directions.

Previously only the sensors could be supplied. The Remote Unit RHPT8 can now also be used with clamping units.

From the stationary side up to four signals can be transmitted, and four channels can be independently controlled.

Housing size	
Type	
Transmission distance	
Installation type	



Remote PNP	
Base PNP	
Assured transmission distance	
Supply voltage U_B incl. ripple	
Voltage drop U_d at I_e	
Rated operational current I_e	
No-load supply current I_0 max.	
Off-state current I_r	
Short circuit protected	
Current draw per input	
Radial offset	
Operating current (for sensors + actuators)	
Output voltage (for sensors + actuators)	
Rated insulation voltage U_i	
Rated current (actuators)	
Ambient temperature range T_a	
Switching frequency f	
Function/Supply voltage indicator	
Degree of protection per IEC 60529	
Housing material	
Material of sensing face	
Connection type	
No. of wires x cross-section	

For your electrical project planning please ask for the user's guide!

90x90x45 mm

Remote unit

3...11 mm

non-flush

90x90x45 mm

Base unit

non-flush

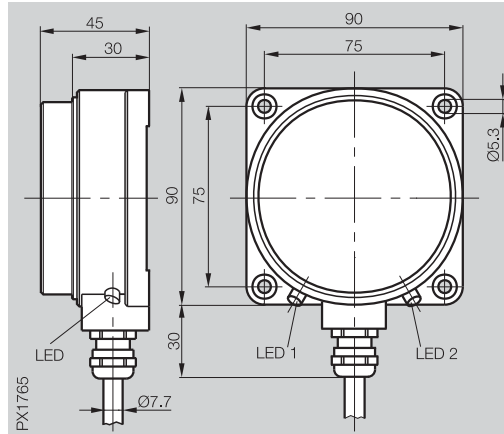
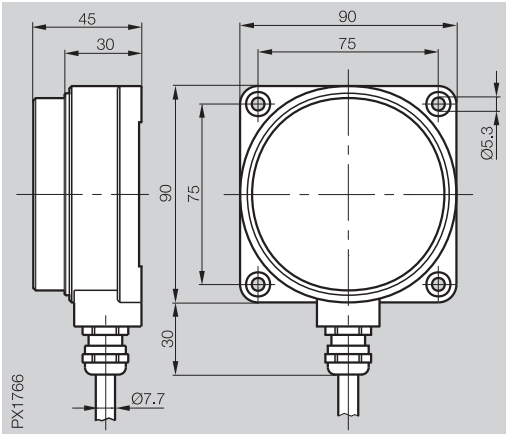

RHPT8 8010P-C3-PU-05

RHPE8 8010P-C3-PU-05

4...9 mm

24 V DC $\pm 10\%$

≤ 1.5 V

≤ 50 mA per output

≤ 800 mA

≤ 80 μ A

yes

≤ 7 mA

$\leq \pm 7$ mm

$\leq \pm 7$ mm

≤ 300 mA

24 ± 1.5 V DC

75 V DC

≤ 50 mA per output

0...+50 °C

0...+50 °C

40 Hz

40 Hz

yes/yes

IP 67

IP 67

AI

AI

ABS/PBT

ABS/PBT

5 m PUR cable

5 m PUR cable

9x0.18 mm² + 2x0.5 mm²

9x0.18 mm² + 2x0.5 mm²

for connecting max. 4 sensors + 4 actuators

The Remote unit is attached on the moving side where the sensors and actuators are located.

The Base unit is connected on the stationary side to the supply voltage and the controller.

